

SOUTH TOWER 5 6-43/F



↓ Panoramic Ocean View ↓
無邊際遠洋景

SOUTH TOWER 5 45-48/F



↓ Panoramic Ocean View ↓
無邊際遠洋景

SOUTH TOWER 5 49-52/F



↓ Panoramic Ocean View ↓
無邊際遠洋景



貝沙灣

SOUTH TOWER 5 53-55/F (DUPLIX UNITS)

South Tower 5 Duplex Unit Area Table 南岸五座複式單位面積圖：

Tower 塔數	Flat 單位	Floor 樓層	Gross Area (sq ft) 建築面積 (平方米)	Saleable Area (Incl. B.W., Bal and UP) (sq ft) 實用面積 (包括窗台、露台及工作平台面積) (平方米)	Balcony Area (sq ft) 露台面積 (平方米)	Bay Window Area (sq ft) 窗台面積 (平方米)	Utility Platform Area (sq ft) 工作平台面積 (平方米)	Flat Roof (sq ft) 平台面積 (平方米)
South Tower 5 南岸五座	A	53-55/F	3,337	2,788	70	0	25	543
	B	53-55/F	4,128	3,449	80	0	29	702

53/F Floor Plan – Lower Duplex Floor
低層複式平面圖

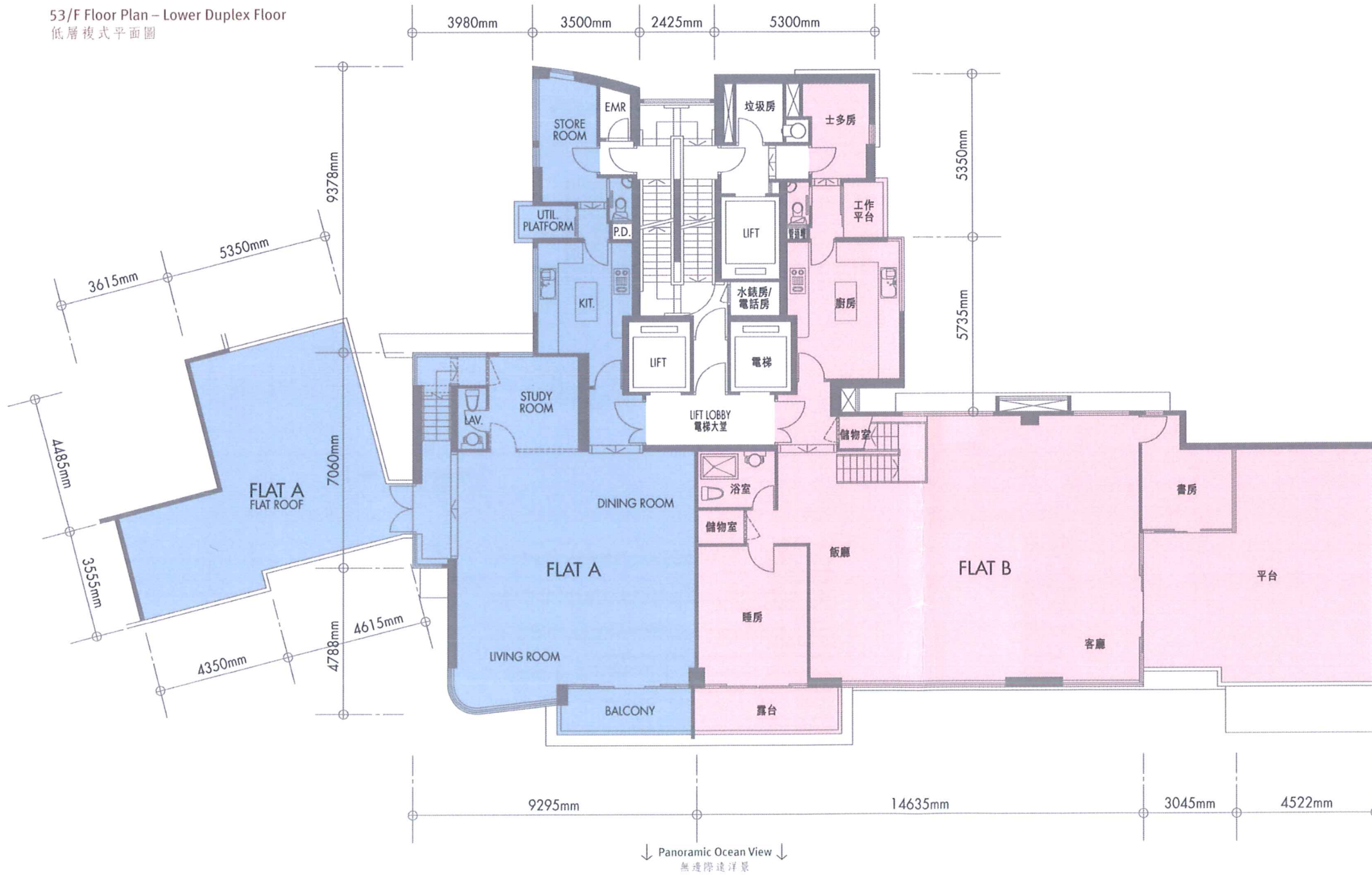

SOUTH TOWER 5 53-55/F (DUPLIX UNITS)



55/F Floor Plan - Upper Duplex Floor
高層複式平面圖

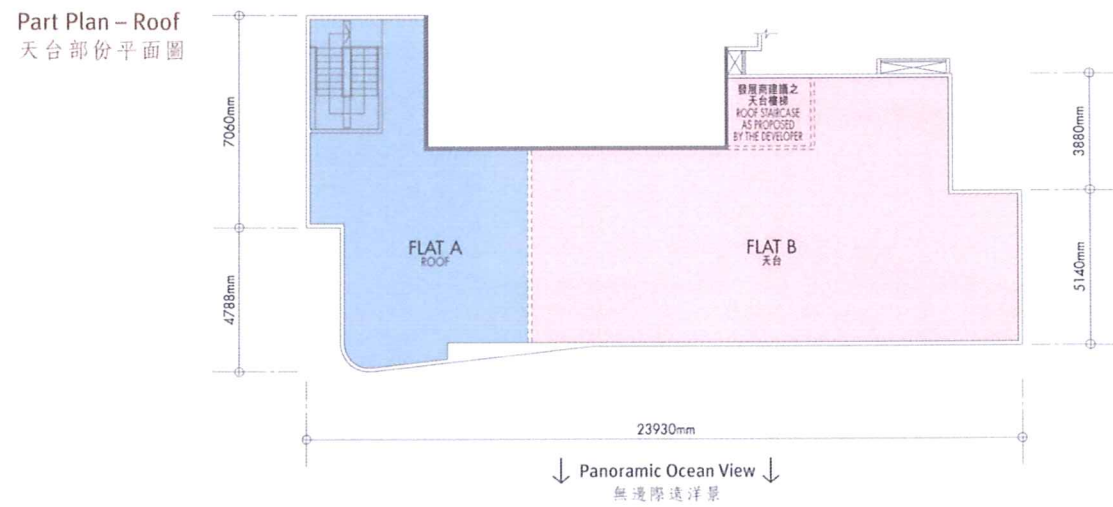
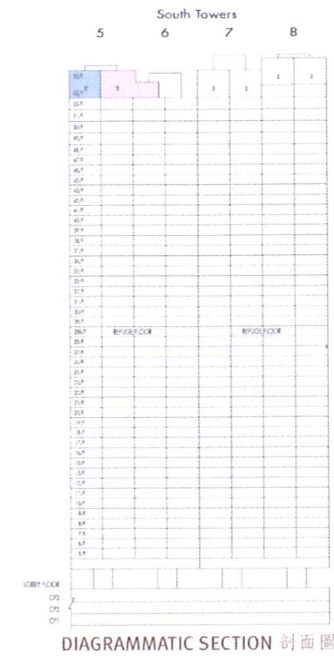
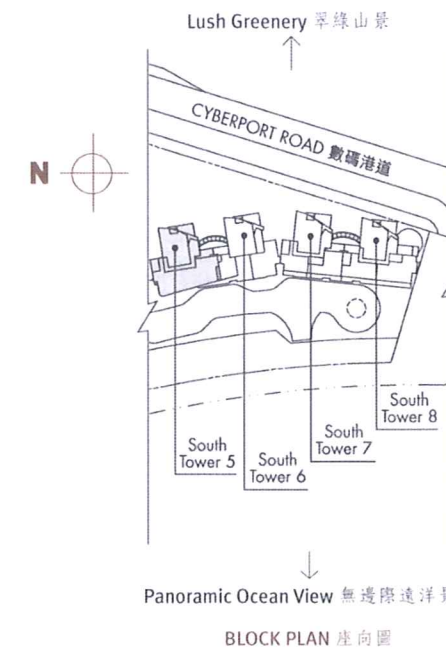

- Notes:
- Gross Area**
Gross Area of the unit shall be the sum of its Saleable Area (including Balcony Area, Bay Window Area, Utility Platform Area and area of non-structural prefabricated external walls), and its apportioned share of the relevant portion of the Common Area.
 - Saleable Area**
Saleable Area shall mean the floor area exclusively allocated to the unit including balconies, bay windows, utility platforms and non-structural prefabricated external walls but excluding Common Area such as staircases, lift shafts and lobbies, etc.
 - Common Area**
Common Area shall include, but not limited to, residential lobbies, lift lobbies, lift shafts, staircases, roof, refuge floor, estate management office, security control room, meter rooms, clubhouse facilities and podium landscaped deck, etc.
 - Gross Area of the unit is calculated in accordance with the following formula:**
Gross Area of the unit = Saleable Area of the unit + $\left\{ \frac{\text{Saleable Area of the unit}}{\text{Total Saleable Areas of all units}} \right\} \times \text{Relevant Portion of Common Area}$
 - Balcony and Utility Platform are Non-enclosed Areas.
 - The internal areas of units on upper floors may be slightly larger than lower floors due to the reducing thickness of structural walls on those floors.
 - Architectural features are on external walls of some of the floors.
 - 28R/F (which is the floor between 28/F and 29/F) is the refuge floor.
 - The floor numberings are such that there are no 14/F, 24/F, 34/F, 44/F and 54/F.
 - All dimensions are for reference only.
 - All areas shown herein are approximate only and may be subject to variation upon completion of construction.
 - The Saleable Areas of the units will be specified in square meters in the Agreement for Sale and Purchase. The Saleable Areas specified above in square feet, which are converted at the rate of 1 square meter = 10.76391 square feet and rounded to the nearest whole square foot, are for reference only and shall be subject to the terms of the Agreement for Sale and Purchase.
 - All plans are subject to final approval by the relevant Government Authorities.
 - Information contained herein is for reference only. All information shall be subject to the terms and conditions of the Agreement for Sale and Purchase. In case of any conflict between the English version and Chinese version of the contents, the English version shall prevail.
 - For fittings & finishes schedule and information for reference, please refer to the sales brochure.
 - Storey Height of Lower Duplex Floor in South Tower 5 is approximately 14.8ft (4.5m) and storey height of Upper Duplex Floor is approximately 11.5ft (3.5m).

- 附註:
- 建築面積**
單位之建築面積指其實用面積(包括露台面積、窗台面積、工作平台面積及非結構預製外牆面積)及按單位面積比例分攤之相關公用地方面積。
 - 實用面積**
實用面積指專為單位之面積,包括露台、窗台、工作平台及非結構預製外牆,但不包括樓梯、升降機機房及大堂等公用地方。
 - 公用地方面積**
公用地方面積包括但不限於大堂、升降機大堂、升降機機房、樓梯、天台、露台、管理處、保安控制室、錶房、住戶會所及平台花園等設施。
 - 建築面積按下列公式計算:**
單位之建築面積 = 單位之實用面積 + $\left\{ \frac{\text{單位之實用面積}}{\text{所有單位之實用面積之總和}} \right\} \times \text{有關單位之公用地方面積}$
 - 露台及工作平台均非圍封範圍。
 - 高層單位的室內面積可能較低層單位較大,因其結構比低層單位較厚。
 - 部份樓層外牆面設有建築裝飾。
 - 28R/F (即28/F及29/F之間)為逃生層。
 - 物業不設有14/F、24/F、34/F、44/F及54/F之樓層。
 - 圖中所有高度單位均按標準用途。
 - 圖類表格中之單位面積只為參考用途,完工後面積可能略有變動。
 - 根據買賣合約,各住宅單位之實用面積的公布與到項,主要用於計算面積,用以釐清之平方呎數,此一至十位小數 = 10.76391 平方呎,此項面積,會四捨五入至最接近的平方呎,僅供參考之用,在物業買賣合約中,所有單位之實用面積均以英文版本為準。
 - 詳細的圖則可以於所有樓宇發展商之圖則中查閱。
 - 所有資料均須以發展商之圖則為準,請參閱圖則。
 - 所有裝修材料均以圖則為準,請參閱圖則。
 - 南區五座之建築樓層高度約14.8呎(4.5米),高層複式樓層高度約11.5呎(3.5米)。